

Monitor PEP™ Series • COP Max 6 Stops

NOTE: ALL SELECTIONS AT RIGHT MUST BE FILLED IN ORDER TO PROCESS YOUR ORDER IN A TIMELY MANNER!

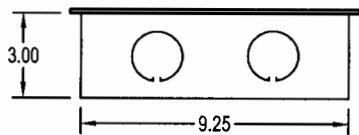
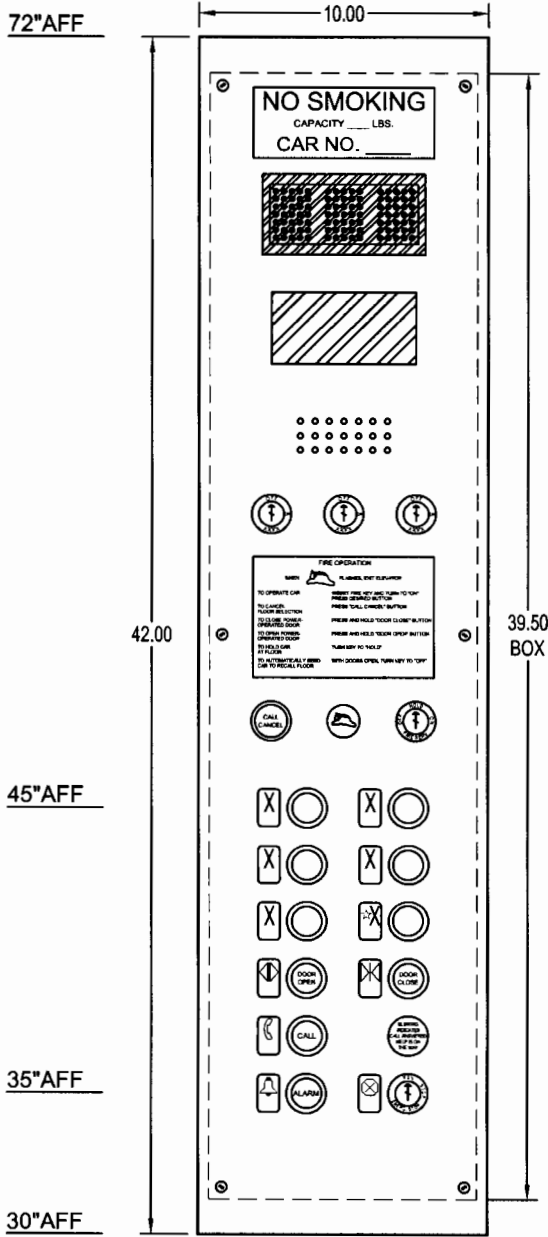

COPH - CAR OPERATING PANEL
QTY _____

COVER MATERIAL

1/8" THK ST/ST #4 BRUSH FINISH W/ BEVELED EDGE

VOLTAGE

120 V 48 V 24 V OTHER _____

PUSH BUTTON STYLE

PC1040 - PLASTIC (STD) TR1100 - ST.ST. W/ 1-3/8" BLACK HALO

FLOOR DESIGNATIONS (6 MAX): _____

MUST SPECIFY EGRESS FLOOR !!

KEYSWITCHES

STANDARD J200 (CHOOSE ANY 3 SWITCHES)

LIGHT FAN FAN (2 SPEED)
 INDP INSP LIGHT/FAN COMBO
 OTHER _____

STOP SWITCHES

J200 KEY EMERGENCY STOP (STD) PULL STOP

BRILLE PLATES

3/4" x 1-5/16" VISIONMARK (BLACK BACKGROUND)
 ST/ST CHARACTER (STANDARD)
 WHITE CHARACTER

FIRE SERVICE (FOR 2004 CODE, SEE PEP - COP 2004)

INCLUDES FIRE KEYSWITCH, FIRE JEWEL
AUDIBLE SIGNAL, CALL CANCEL BUTTON
 J217 - NATIONAL CODE 1996 2000
 OTHER _____
 NOT REQ'D (BLANK INSERTS FOR FUTURE USE)

DIGITAL (WITH PASSING CHIME)

2" DOT MATRIX (2 CHAR. W/ ARROWS)
WITH BUILT IN DRIVER
SIGNAL VOLTAGE: _____ VAC or VDC (MUST SPECIFY)
***NOTE: IF VDC - PLEASE CHECK ONE
 POSITIVE COMMON NEGATIVE COMMON
(NOTE: WORKS W/ BINARY OR ONE LINE PER FLOOR)

2" E-MOTIVE SEGMENTED (2 CHAR. W/ ARROWS)

MUST SUPPLY FOLLOWING INFORMATION !!

ENCODER REQUIRED NOT REQUIRED
VOLTAGE FROM CONTROLLER: _____

SIGNAL FORMAT:
 BINARY 1 LINE PER FLOOR

NO DISPLAY, PASSING CHIME ONLY

EMERGENCY LIGHT

REQUIRED

COMMUNICATIONS

INCLUDES CALL BUTTON, CALL ACK JEWEL
 EMS G3PNB HANDSFREE PHONE
 NOT REQUIRED

ENGRAVING

ALL ENGRAVING ON INLAID PLATES
 PHASE II FIRE INSTRUCTIONS
 NO SMOKING
 CAPACITY _____ LBS } INCORPORATED ON 1 PLATE
 CAR NO. _____

NOTES

HINGES: RIGHT (STD) LEFT

NO WIRING

MOUNTING SCREWS: 8-32 x 1"L. SPANNER HEAD



MONITOR A Janus Product Line
125 Ricefield Lane, Hauppauge, New York 11788
Phone: 631-543-4334 Fax: 631-543-4372

TOLERANCES	CUSTOMER		
DECIMAL ±.063	JOB REFERENCE		
FRACTIONAL 1/32	CONTACT NAME	PHONE NUMBER	
ANGULAR 1/2°	DRAWING NUMBER	DATE	ENGINEER